

Rev	Revision Description	Date(Y/M/D)	By
0	Original Plan Prepared	2014/09/19	DC
1	Construction Plan Based on Rev.0 (2014/09/12) Except for New Construction Corridor: Shape, Label, Area Table & ePass Corrected Area on (S1)	2014/12/31	DC

NOTES:

- Co-ordinates are NAD 83 Grid, UTM Zone 9 and Zone 10. Distances shown are in metres and decimals thereof. Chainages are two-dimensional and are on pipeline ditchline. Pipeline segment length derived from ditchline chainages.
- Fault Lines data has been provided from BGC Engineering Inc. Desktop Study dated December 20, 2013.
- Water crossing information has been provided by Stantec. Wetlands data has been provided by Stantec dated August 29, 2014. Freshwater Atlas wetlands outside of construction corridor have been removed from scenery.
- Cutblock data is confirmed using information from the Government of BC websites for Forest MapView and MapBC.
- This pipeline section is partially within the Agricultural Land Reserve.
- Field Survey Completed July 15, 2014
- This plan represents the best information available at the time of survey. Focus Surveys and its employees take no responsibility for the location of any underground conduits, pipes, or other facilities whether shown on or omitted from this plan. All underground installations should be located by the respective authorities prior to construction.

LEGEND
Proposed Pipeline R/W shown thus:
Proposed Temp. Workspaces shown thus:
Proposed Log Decks & Storage Sites shown thus:
Right of Way shown thus:
Roads shown thus:
Highway shown thus:
Railway line shown thus:
Seismic line/trail shown thus:
Recreation Tenure shown thus:
Drainages shown thus:
Buried cable shown thus:
Buried pipe shown thus:
Overhead powerline shown thus:
Riparian Reserve Zone shown thus:
Riparian Management Zone shown thus:
Forest Cover Reserve shown thus:
Archaeological site shown thus:
Agricultural Land Reserve shown thus:
Coal Tenure by shown thus:
Cutblock by shown thus:
Fence by shown thus:
Fish/Wildlife Reserve by shown thus:
Grazing Tenure by shown thus:
Mineral Claim by shown thus:
Tree Farm Licence shown thus:
Quarry Reserve by shown thus:
Ungulate Winter Range by shown thus:
Visual Land Inventory shown thus:
Watershed Reserve by shown thus:
Wind Tenure by shown thus:
Woodlot by shown thus:
Fault Line shown thus:
Misc. Reserve/Notation by shown thus:
Misc. Licence/Permit by shown thus:
Nisga'a Reserve Zone shown thus:
Crossings shown thus:
Old Growth Management Area shown thus:
Residences shown thus:
Nisga'a Lands shown thus:
Nisga'a Village Lands shown thus:
Lava Bed Park shown thus:

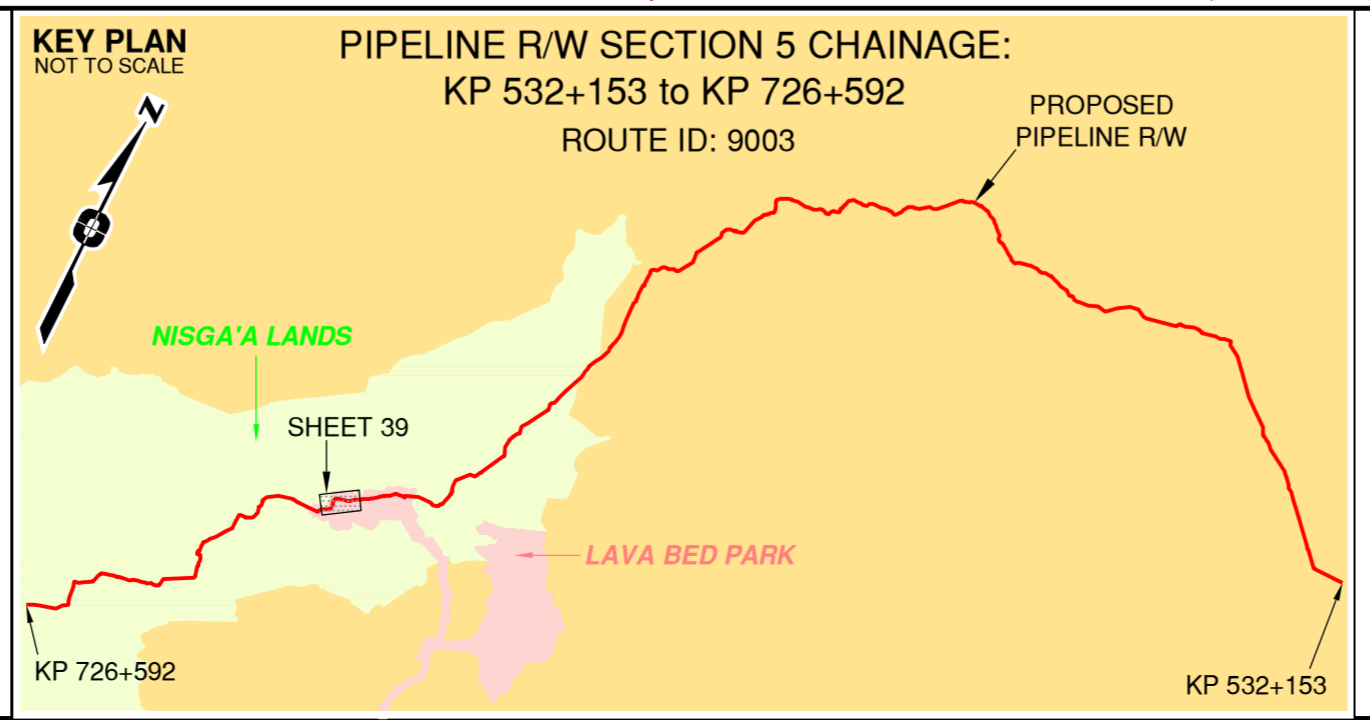

APPROVED BY _____

PROJECT ENGINEER _____

No.	STATION	DESCRIPTION	OWNER
W02009	(S1) 681-810	Trib to the Nass River / Non-classified drainage / RRZ=0 RMZ=0	N 6115736 E 487605 ILMB

TABLE OF CROSSINGS

Prince Rupert Gas Transmission Project

TransCanada In business to deliver

PRINCE RUPERT GAS TRANSMISSION LTD.

PROPOSED VARIABLE WIDTH (32 TO 90m) PIPELINE R/W FROM d-59-I, 93-M-5 TO c-71-D, 103-P-3 (S1), c-71-D TO d-63-D, 103-P-3 (S2 & S3) & FROM d-63-D, 103-P-3 TO a-71-J, 103-I-13 (S4) (SHEET CHAINAGE: 681+153 TO 685+539)

Unsurveyed Crown Land/Crown Land/Private Land/Nisga'a Lands & Village Lands/Lava Bed Park Cassiar District & Range 5 Coast District

The intended plot size of this plan is 864mm in width by 560mm in height when plotted at a scale of 1: 5000 (use D size sheet)

BCGS: 1031.092/93.93M.042/51/52/61, 103P.003/04/14/15/25/26/36/46/56/67/68/69/70

Sheet 39 of 49

FOCUS Focus Surveys (BC) Limited Partnership 10715 - 100th Avenue Fort St. John BC V1J 1Z3 250.757.0300 www.focus.ca	FOCUS: 130275CP05R1 AFE: 5005948 TCPL: 004776-09-ML-03-175 ePASS: 10048852	REV. 1
--	---	------------------

10/31/2014 9:22:35 AM



PROPOSED AREAS

Pipeline R/W	5.29 ha
Workspace	3.97 ha
Log Deck	1.50 ha
TOTAL	10.76 ha

**DL 7280
PLAN NR51
Canyon City
(Gitwinkshlkw)
Village Lands**

**DL 1093
PLAN NR51
Canyon City
(Gitwinkshlkw)
Village Lands**

Rev	Revision Description	Date(Y/M/D)	By
0	Original Plan Prepared	2014/09/19	DC
1	Construction Plan Based on Rev.0 (2014/09/12) Except for New Construction Corridor: Shape, Label, Area Table & ePass Corrected Area on (S1)	2014/12/31	DC

LEGEND

Proposed Pipeline R/W shown thus:	Fish/Wildlife Reserve body shown thus:
Proposed Temp. Workspaces shown thus: TWS / TWS	Grazing Tenure body shown thus:
Proposed Log Decks & Storage Sites shown thus:	Mineral Claim body shown thus:
Right of Way shown thus:	Tree Farm Licence shown thus:
Roads shown thus:	Quarry Reserve body shown thus:
Highway shown thus:	Ungulate Winter Range body shown thus: UWR
Railway line shown thus:	Visual Land Inventory shown thus:
Seismic line/trail shown thus:	Watershed Reserve body shown thus:
Recreation Tenure shown thus:	Wind Tenure body shown thus:
Drainages shown thus:	Woodlot body shown thus:
Buried cable shown thus:	Fault Line shown thus:
Buried pipe shown thus:	Misc Reserve/Notation body shown thus:
Overhead powerline shown thus:	Misc Licence/Permit body shown thus:
Riparian Reserve Zone shown thus:	Stantec Wetland / Classification shown thus:
Riparian Management Zone shown thus:	Crossings shown thus:
Forest Cover Reserve shown thus:	Old Growth Management Area shown thus:
Archaeological site shown thus:	Residences shown thus:
Agricultural Land Reserve body shown thus: ALR	Nisga'a Lands shown thus:
Coal Tenure body shown thus:	Nisga'a Village Lands shown thus:
Cutblock body shown thus:	Lava Bed Park shown thus:
Fence body shown thus:	

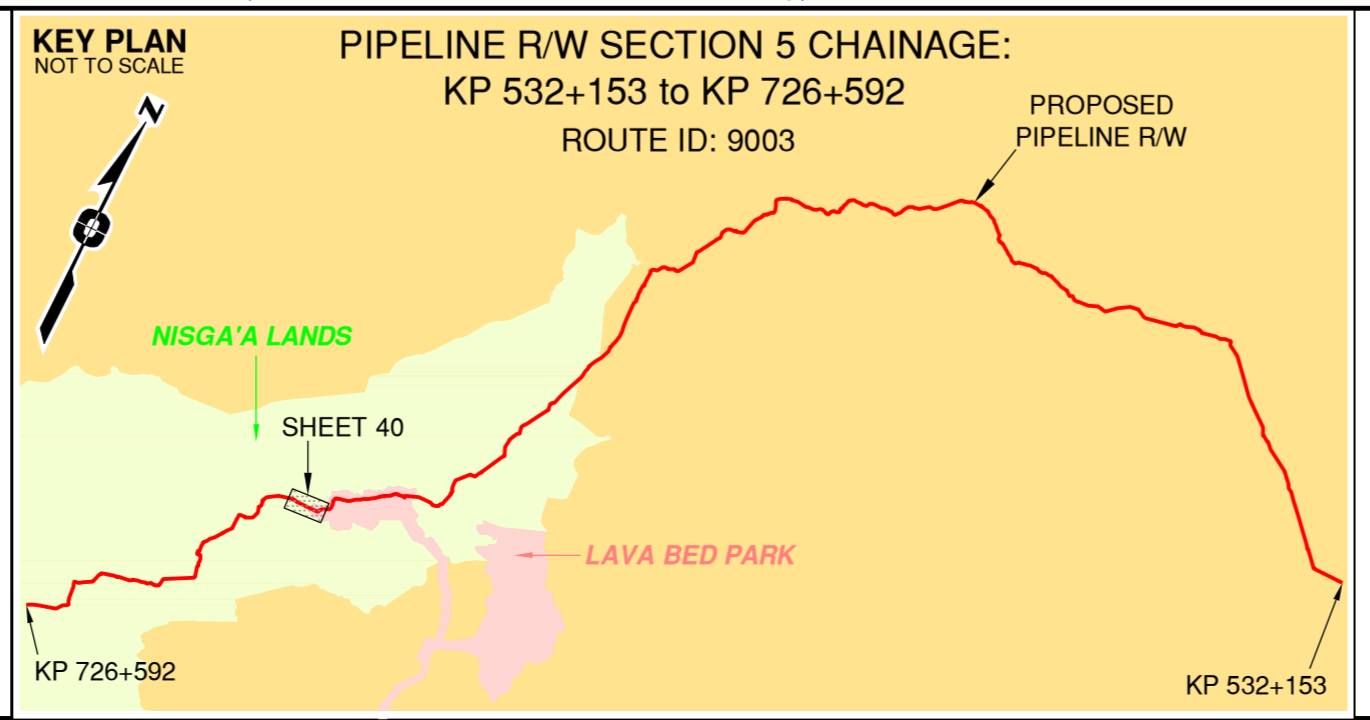

APPROVED BY _____

PROJECT ENGINEER _____

No.	STATION	DESCRIPTION	OWNER
W02747	(S1) 689+217	Trib to Nass River / S4 / RRZ-0 RMZ=30	N 6113517 E 481719
W02874	(S1) 689+012	Trib to Nass River / S4 / RRZ-0 RMZ=30	N 6113524 E 481921
W02011	(S1) 688+979	Trib to Nass River / Non-classified drainage / RRZ-0 RMZ=0	N 6113519 E 481954
W02012	(S1) 688+686	Nass River Side Channel / S1 / RRZ=50 RMZ=20	N 6113438 E 482234
W02709	(S1) 688+560	Trib to Nass River / S4 / RRZ-0 RMZ=30	N 6113408 E 482356
T00600	(S1) 687+747	Road / Condition Unknown	N 6113392 E 483165
W02010	(S1) 686+799	Trib to Ksi Ts'ooohi Ts'ap Creek / S1 / RRZ=50 RMZ=20	N 6113343 E 484112
W02656	(S1) 686+733	Trib to Ksi Ts'ooohi Ts'ap Creek / S4 / RRZ-0 RMZ=30	N 6113339 E 484178
U00059	(S1) 686+266	Nisga'a Highway 113 / Paved	N 6113315 E 484645
U00048	(S1) 686+251	Overhead Powerline	N 6113314 E 484659
T00596	(S1) 686+188	Trail / Condition Unknown	N 6113315 E 484720

Prince Rupert Gas Transmission Project

TransCanada
In business to deliver

PRINCE RUPERT GAS TRANSMISSION LTD.

PROPOSED VARIABLE WIDTH (32 to 90m) PIPELINE R/W FROM d-59-I, 93-M-5 TO c-71-D, 103-P-3 (S1), c-71-D TO d-63-D, 103-P-3 (S2 & S3) & FROM d-63-D, 103-P-3 TO a-71-J, 103-I-13 (S4) (SHEET CHAINAGE: 685+539 TO 689+496)

Unsurveyed Crown Land/Crown Land/Private Land/Nisga'a Lands & Village Lands/Lava Bed Park
Cassiar District & Range 5 Coast District

The intended plot size of this plan is 854mm in width by 560mm in height when plotted at a scale of 1: 5000 (use D size sheet)

BCGS: 1031.092/93.93M.042/51/52/61, 103P.003/04/14/15/25/26/36/46/56/67/68/69/70

Sheet 40 of 49

FOCUS Focus Surveys (BC) Limited Partnership 10715 - 100th Avenue, Fort St. John, BC V1J 1Z3 - 250.757.0300 - www.focus.ca	FOCUS: 130275CP05R1 AFFE: 5005948 TCPL: 004776-09-ML-03-176 ePASS: 10048852	REV. 1
--	--	------------------



Rev	Revision Description	Date(Y/M/D)	By
0	Original Plan Prepared	2014/09/19	DC
1	Construction Plan Based on Rev.0 (2014/09/12) Except for New Construction Corridor: Shape, Label, Area Table & ePass Corrected Area on (S1)	2014/12/31	DC

LEGEND	
Proposed Pipeline R/W shown thus: [Red line]	Fish/Wildlife Reserve body shown thus: [Blue line]
Proposed Temp. Workspaces shown thus: TWS / TWS	Grazing Tenure body shown thus: [Green line]
Proposed Log Decks & Storage Sites shown thus: [Yellow box]	Mineral Claim body shown thus: [Purple line]
Right of Way shown thus: [Green line]	Tree Farm Licence shown thus: [Green line]
Roads shown thus: [Red line]	Quarry Reserve body shown thus: [Red line]
Highway shown thus: [Red line]	Ungulate Winter Range body shown thus: UWR
Railway line shown thus: [Red line]	Visual Land Inventory shown thus: [Red line]
Seismic line/trail shown thus: [Red line]	Watershed Reserve body shown thus: [Blue line]
Recreation Tenure shown thus: [Red line]	Wind Tenure body shown thus: [Red line]
Drainages shown thus: [Blue line]	Woodlot body shown thus: [Green line]
Buried cable shown thus: [Red line]	Fault Line shown thus: [Red line]
Buried pipe shown thus: [Red line]	Misc. Reserve/Notation body shown thus: [Red line]
Overhead powerline shown thus: [Red line]	Misc. Licence/Permit body shown thus: [Red line]
Riparian Reserve Zone shown thus: [Red line]	Stantec Wetland / Classification shown thus: [Red line]
Riparian Management Zone shown thus: [Red line]	Crossings shown thus: [Red line]
Forest Cover Reserve shown thus: [Red line]	Old Growth Management Area shown thus: [Red line]
Archaeological site shown thus: [Red line]	Residences shown thus: [Red line]
Agricultural Land Reserve body shown thus: ALR	Nisga'a Lands shown thus: [Red line]
Coal Tenure body shown thus: [Red line]	Nisga'a Village Lands shown thus: [Red line]
Cutblock body shown thus: [Red line]	Lava Bed Park shown thus: [Red line]
Fence body shown thus: [Red line]	

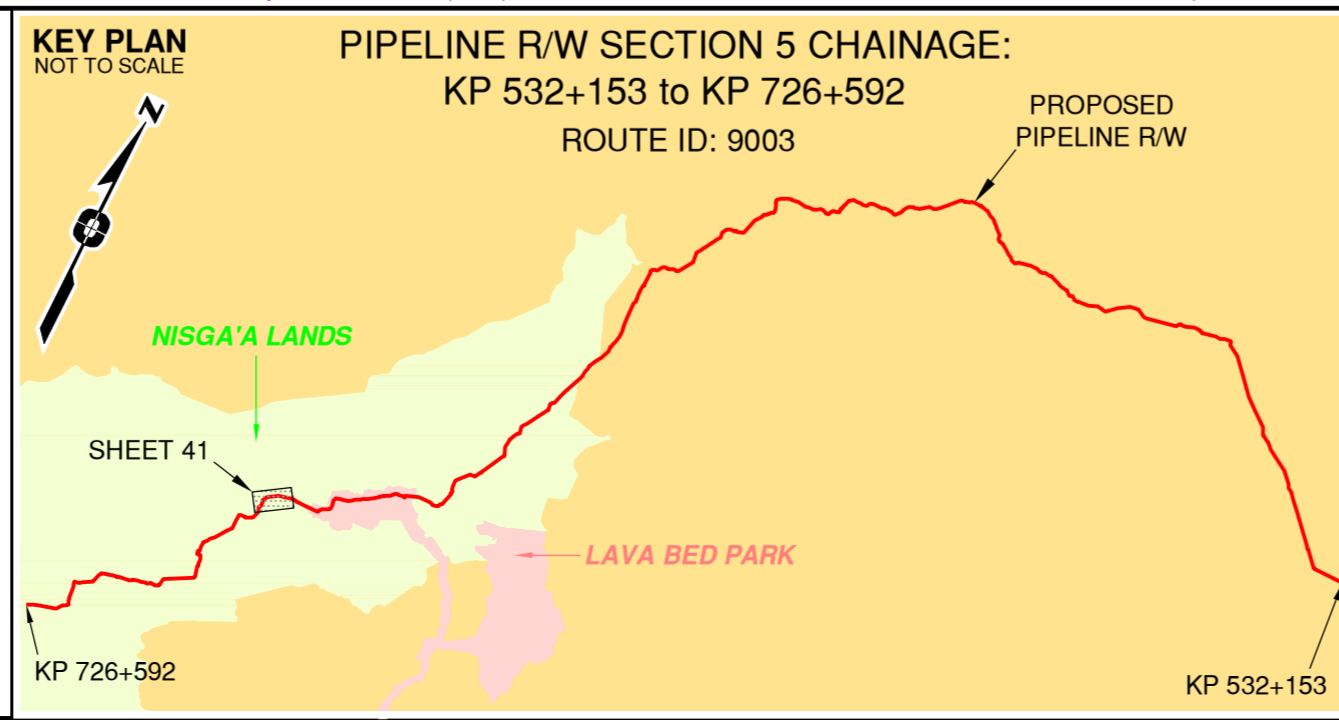

APPROVED BY

PROJECT ENGINEER

No.	STATION	DESCRIPTION	NAD 83 UTM ZONE	OWNER
100602	(S1) 693+655	Forestry Road / Condition Unknown / R12576 D (Retired)	N 6111243 E 478764	Nisga'a Lisims Government
W02015	(S1) 693+369	Kwinyarth Creek / S2 / RR2=30 RMZ=20	N 6111458 E 478778	ILMB
W02014	(S1) 693+239	Trib to Kwinyarth Crk / Non-classified drainage / RR2=0 RMZ=0	N 6111547 E 478860	ILMB
W02018	(S1) 692+985	Trib to Kwinyarth Crk / Beaver Dam Complex / RR2=0 RMZ=30	N 6111789 E 478916	ILMB
W02631	(S1) 692+954	Trib to Nass River / RR2=0 RMZ=20	N 6111817 E 478903	ILMB
U00605	(S1) 692+567	Nisga'a Highway 113 / Paved	N 6112177 E 478910	MOTI
U00022	(S1) 692+552	Overhead Powerline	N 6112186 E 478896	BC Hydro
W02760	(S1) 691+698	Trib to Nass River / S4 / RR2=0 RMZ=30	N 6112825 E 479365	ILMB
U00601	(S1) 691+450	Trail / Condition Unknown	N 6112938 E 479585	Nisga'a Lisims Government
W02200	(S1) 691+378	Nass River Side Channel / S1 / RR2=50 RMZ=20	N 6112971 E 479650	ILMB
W02013	(S1) 690+834	Trib to Nass River / RR2=30 RMZ=20	N 6113217 E 480134	ILMB
W02749	(S1) 690+007	Trib to Nass River / S4 / RR2=0 RMZ=30	N 6113387 E 480939	ILMB
W02722	(S1) 689+997	Trib to Nass River / S4 / RR2=0 RMZ=30	N 6113389 E 480949	ILMB

Prince Rupert Gas Transmission Project

TransCanada
In business to deliver

PRINCE RUPERT GAS TRANSMISSION LTD.

PROPOSED VARIABLE WIDTH (32 to 90m) PIPELINE R/W FROM d-59-I, 93-M-5 TO c-71-D, 103-P-3 (S1), c-71-D TO d-63-D, 103-P-3 (S2 & S3) & FROM d-63-D, 103-P-3 TO a-71-J, 103-I-13 (S4) (SHEET CHAINAGE: 689+496 TO 693+864)

Unsurveyed Crown Land/Crown Land/Private Land/Nisga'a Lands & Village Lands/Lava Bed Park/Cassiar District & Range 5 Coast District

The intended plot size of this plan is 864mm in width by 560mm in height when plotted at a scale of 1: 5000 (use D size sheet)

BCGS: 1031.092/93.93M.042/51/52/61.103P.00304/14/15/25/26/36/46/56/67/68/69/70

Sheet 41 of 49

FOCUS
Focus Surveys (BC) Limited Partnership
10715 - 100th Avenue, Fort St. John, BC
V1J 1Z3, 250.787.0300, www.focus.ca

FOCUS: 130275CP05R1
AFE: 5005948
TCPL: 004776-09-ML-03-177
ePASS: 10048852

REV. 1



Rev	Revision Description	Date(Y/M/D)	By
0	Original Plan Prepared	2014/09/19	DC
1	Construction Plan Based on Rev.0 (2014/09/12) Except for New Construction Corridor: Shape, Label, Area Table & ePass Corrected Area on (S1)	2014/12/31	DC

LEGEND	
Proposed Pipeline R/W shown thus:	Fish/Wildlife Reserve body shown thus:
Proposed Temp. Workspaces shown thus: TWS / TWS	Grazing Tenure body shown thus:
Proposed Log Decks & Storage Sites shown thus:	Mineral Claim body shown thus:
Right of Way shown thus:	Tree Farm Licence shown thus:
Roads shown thus:	Quarry Reserve body shown thus:
Highway shown thus:	Ungulate Winter Range body shown thus:
Railway line shown thus:	Visual Land Inventory shown thus:
Seismic line/trail shown thus:	Watershed Reserve body shown thus:
Recreation Tenure shown thus:	Wind Tenure body shown thus:
Drainages shown thus:	Woodlot body shown thus:
Buried cable shown thus:	Fault Line shown thus:
Buried pipe shown thus:	Misc. Reserve/Notation body shown thus:
Overhead powerline shown thus:	Misc. Licence/Permit body shown thus:
Riparian Reserve Zone shown thus:	Stantec Wetland / Classification shown thus:
Crossings shown thus:	Residences shown thus:
Forest Cover Reserve shown thus:	Nisga'a Lands shown thus:
Archaeological site shown thus:	Nisga'a Village Lands shown thus:
Agricultural Land Reserve body shown thus:	Lava Bed Park shown thus:
Coal Tenure body shown thus:	Cutblock body shown thus:
Cutblock data is confirmed using information from the Government of BC websites for Forest MapView and MapBC.	Fence body shown thus:

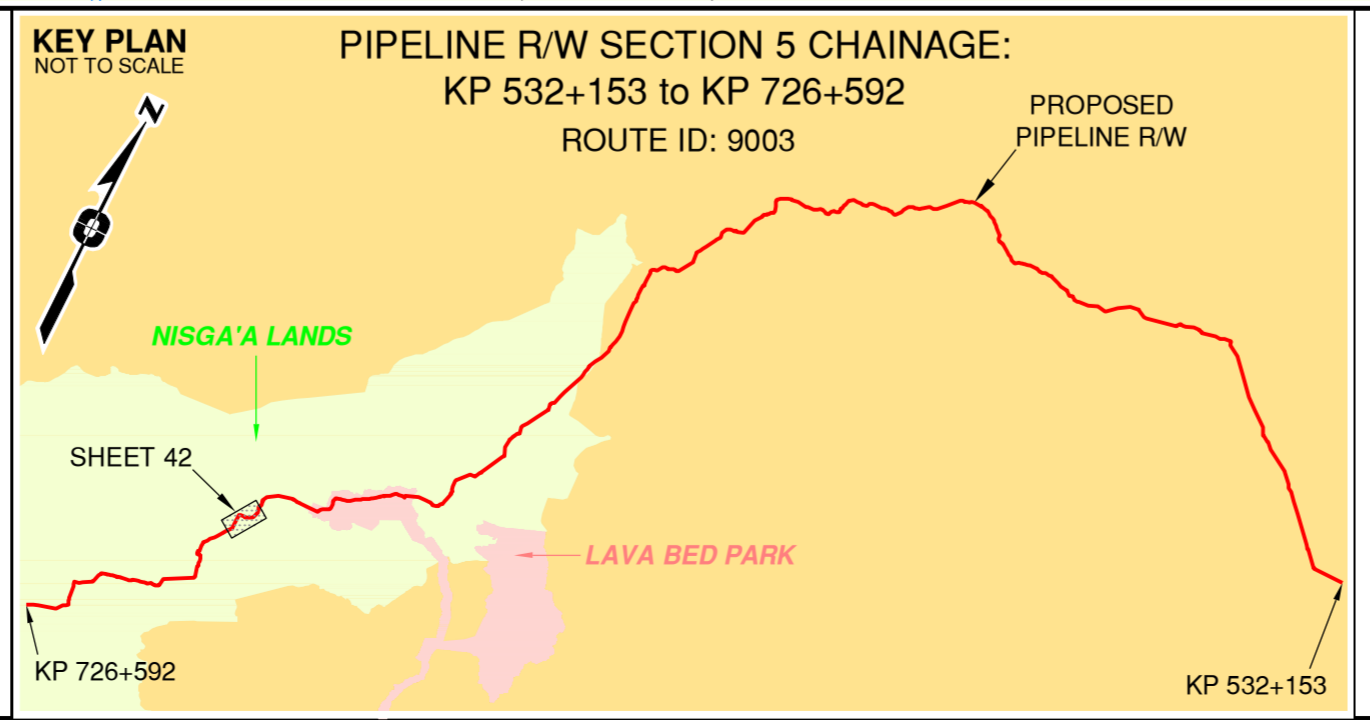

APPROVED BY _____

PROJECT ENGINEER _____

No.	STATION	DESCRIPTION	NAD 83 UTM ZONE	OWNER
W02025	(S1) 697+793	Trib to Ansedagan Creek / S4 / RRZ=0 RMZ=30	N 6108408 E 477019	ILMB
W02024	(S1) 697+738	Trib to Nass River / S6 / RRZ=0 RMZ=20	N 6108463 E 477023	ILMB
W02023	(S1) 697+667	Trib to Nass River / S4 / RRZ=0 RMZ=30	N 6108534 E 477027	ILMB
T01020	(S1) 696+743	Trail / Condition Unknown	N 6109455 E 477091	Nisga'a Lisims Government
T00726	(S1) 696+590	Forestry Road / LGGR / R12576 A (Retired)	N 6109608 E 477105	Nisga'a Lisims Government
W02630	(S1) 696+539	Trib to Ansedagan Creek / S4 / RRZ=0 RMZ=30	N 6109659 E 477110	ILMB
W02022	(S1) 696+449	Ansedagan Creek / S2 / RRZ=30 RMZ=20	N 6109748 E 477119	ILMB
W02017	(S1) 694+800	Trib to Ansedagan Creek / No visible channel / RRZ=0 RMZ=0	N 6110197 E 478571	ILMB
T00604	(S1) 693+981	Trail / Condition Unknown	N 6110935 E 478870	Nisga'a Lisims Government
T00603	(S1) 693+944	Trail / Condition Unknown	N 6110970 E 478858	Nisga'a Lisims Government

Prince Rupert Gas Transmission Project

PRINCE RUPERT GAS TRANSMISSION LTD.

PROPOSED VARIABLE WIDTH (32 to 90m) PIPELINE R/W FROM d-59-I, 93-M-5 TO c-71-D, 103-P-3 (S1), c-71-D TO d-63-D, 103-P-3 (S2 & S3) & FROM d-63-D, 103-P-3 TO a-71-J, 103-I-13 (S4) (SHEET CHAINAGE: 693+864 TO 698+268)

Unsurveyed Crown Land/Crown Land/Private Land/Nisga'a Lands & Village Lands/Lava Bed Park Cassiar District & Range 5 Coast District

The intended plot size of this plan is 864mm in width by 560mm in height when plotted at a scale of 1: 5000 (use D size sheet)

BCGS: 1031.092/93.93M.042/51/52/61, 103P.003/04/14/15/25/26/36/46/56/67/68/69/70

FOCUS Surveys (BC) Limited Partnership
10715 - 100th Avenue Fort St. John BC V1J 1Z3 250.757.0300 www.focus.ca

FOCUS: 130275CP05R1
TCPL: 004776-09-ML-03-178
ePASS: 10048852

REV. 1



Rev	Revision Description	Date(Y/M/D)	By
0	Original Plan Prepared	2014/09/19	DC
1	Construction Plan Based on Rev.0 (2014/09/12) Except for New Construction Corridor: Shape, Label, Area Table & ePass Corrected Area on (S1)	2014/12/31	DC

LEGEND	
Proposed Pipeline R/W shown thus: [Symbol]	Fish/Wildlife Reserve body shown thus: [Symbol]
Proposed Temp. Workspaces shown thus: TWS / TWS	Grazing Tenure body shown thus: [Symbol]
Proposed Log Decks & Storage Sites shown thus: [Symbol]	Mineral Claim body shown thus: [Symbol]
Right of Way shown thus: [Symbol]	Tree Farm Licence shown thus: [Symbol]
Roads shown thus: [Symbol]	Quarry Reserve body shown thus: [Symbol]
Highway shown thus: [Symbol]	Ungulate Winter Range body shown thus: UWR
Railway line shown thus: [Symbol]	Visual Land Inventory shown thus: [Symbol]
Seismic line/trail shown thus: [Symbol]	Watershed Reserve body shown thus: [Symbol]
Recreation Tenure shown thus: [Symbol]	Wind Tenure body shown thus: [Symbol]
Drainages shown thus: [Symbol]	Woodlot body shown thus: [Symbol]
Buried cable shown thus: [Symbol]	Fault Line shown thus: [Symbol]
Buried pipe shown thus: [Symbol]	Misc. Reserve/Notation body shown thus: [Symbol]
Overhead powerline shown thus: [Symbol]	Misc. Licence/Permit body shown thus: [Symbol]
Riparian Reserve Zone shown thus: [Symbol]	Stantec Wetland / Classification shown thus: [Symbol]
Riparian Management Zone shown thus: [Symbol]	Crossings shown thus: [Symbol]
Forest Cover Reserve shown thus: [Symbol]	Old Growth Management Area shown thus: [Symbol]
Archaeological site shown thus: [Symbol]	Residences shown thus: [Symbol]
Agricultural Land Reserve body shown thus: ALR	Nisga'a Lands shown thus: [Symbol]
Coal Tenure body shown thus: [Symbol]	Nisga'a Village Lands shown thus: [Symbol]
Cutblock body shown thus: [Symbol]	Lava Bed Park shown thus: [Symbol]
Fence body shown thus: [Symbol]	

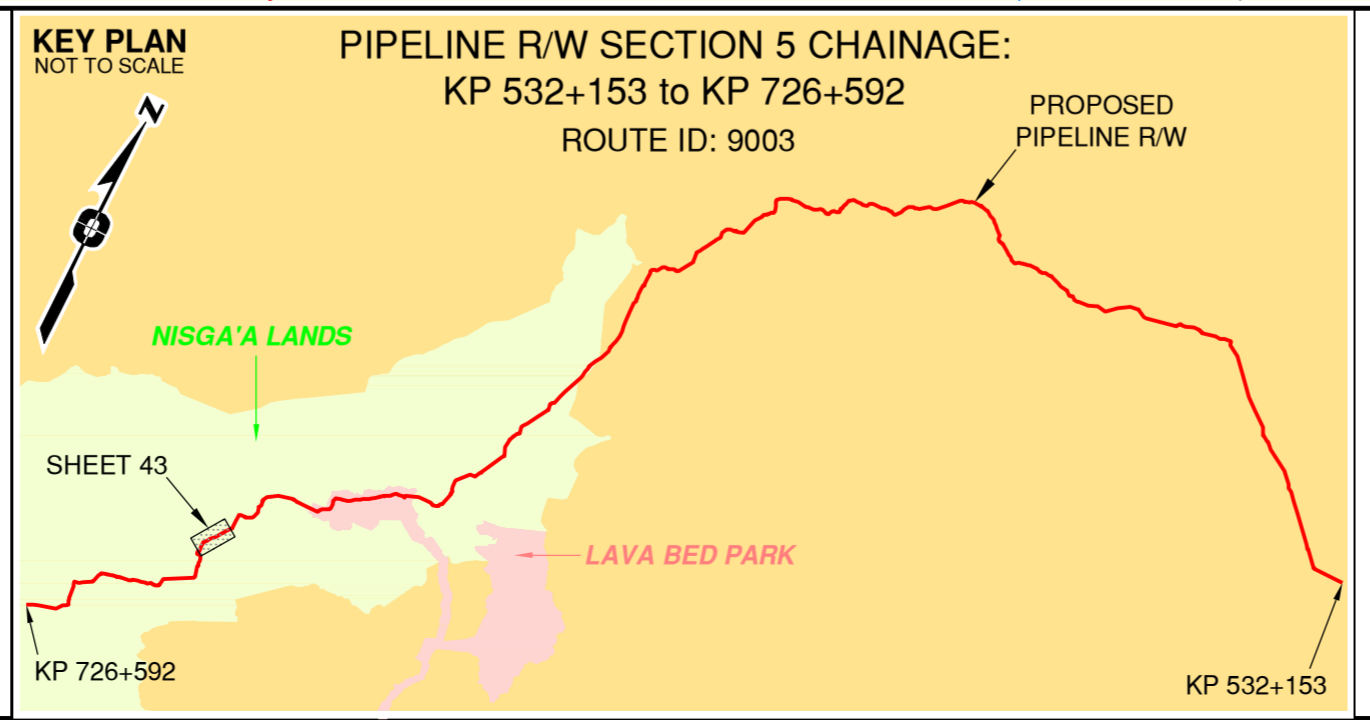

APPROVED BY: _____

PROJECT ENGINEER: _____

No.	STATION	DESCRIPTION	NAD 83 UTM ZONE	OWNER
W02032	(S1) 701+919	K'emamalth Creek / S1 / RRZ=50 RMZ=20	N 6105209 E 4746664	ILMB
W00609	(S1) 701+733	Forestry Road / LGGR / R07817 A	N 6105394 E 4746665	Coast Tsimshian Res. LP
W02031	(S1) 701+607	Trib to K'emamalth Crk / Non-classified drain / RRZ=0 RMZ=0	N 6105520 E 4746669	ILMB
W00608	(S1) 701+468	Trail / Condition Unknown	N 6105658 E 4746662	Nisga'a Lisims Government
W02030	(S1) 699+926	Trib to Nass River / Non-classified drainage / RRZ=0 RMZ=0	N 6106780 E 4756988	ILMB
W02756	(S1) 699+730	Trib to Nass River / S4 / RRZ=0 RMZ=30	N 6106921 E 475834	ILMB
W02757	(S1) 699+673	Trib to Nass River / S4 / RRZ=0 RMZ=30	N 6106965 E 4758689	ILMB
W01029	(S1) 699+445	Trail / Condition Unknown	N 6107142 E 476013	Nisga'a Lisims Government
W02029	(S1) 699+221	Trib to Nass River / S4 / RRZ=0 RMZ=30	N 6107315 E 476155	ILMB
W02758	(S1) 699+095	Trib to Nass River / S4 / RRZ=0 RMZ=30	N 6107415 E 476231	ILMB
W02759	(S1) 698+952	Trib to Nass River / S4 / RRZ=0 RMZ=30	N 6107537 E 476305	ILMB
W02028	(S1) 698+473	Trib to Nass River / S6 / RRZ=0 RMZ=20	N 6107876 E 476644	ILMB
W02027	(S1) 698+420	Trib to Nass River / S4 / RRZ=0 RMZ=30	N 6107913 E 476682	ILMB
W02026	(S1) 698+298	Trib to Nass River / S4 / RRZ=0 RMZ=30	N 6107999 E 476768	ILMB

Prince Rupert Gas Transmission Project

TransCanada
In business to deliver

PRINCE RUPERT GAS TRANSMISSION LTD.

PROPOSED VARIABLE WIDTH (32 to 90m) PIPELINE R/W FROM d-59-I, 93-M-5 TO c-71-D, 103-P-3 (S1), c-71-D TO d-63-D, 103-P-3 (S2 & S3) & FROM d-63-D, 103-P-3 TO a-71-J, 103-I-13 (S4) (SHEET CHAINAGE: 698+268 TO 702+199)

Unsurveyed Crown Land/Crown Land/Private Land/Nisga'a Lands & Village Lands/Lava Bed Park
Cassiar District & Range 5 Coast District

BCGS: 1031.092/93.93M.042/51/52/61.103P.003/04/14/15/25/26/36/46/56/67/68/69/70

The intended plot size of this plan is 854mm in width by 560mm in height when plotted at a scale of 1: 5000 (use D size sheet)

FOCUS
Focus Surveys (BC) Limited Partnership
10715 - 100th Avenue Fort St. John BC
V1J 1Z3 250.757.0300 www.focus.ca

FOCUS: 130275CP05R1
AFE: 5005948
TCPL: 004776-09-ML-03-179
ePASS: 10048852

Sheet 43 of 49

REV. 1

TABLE OF CROSSINGS



Rev	Revision Description	Date(Y/M/D)	By
0	Original Plan Prepared	2014/09/19	DC
1	Construction Plan Based on Rev.0 (2014/09/12) Except for New Construction Corridor: Shape, Label, Area Table & ePass Corrected Area on (S1)	2014/12/31	DC

LEGEND	
Proposed Pipeline R/W shown thus: [Symbol]	Fish/Wildlife Reserve body shown thus: [Symbol]
Proposed Temp. Workspaces shown thus: [Symbol]	Grazing Tenure body shown thus: [Symbol]
Proposed Log Decks & Storage Sites shown thus: [Symbol]	Mineral Claim body shown thus: [Symbol]
Right of Way shown thus: [Symbol]	Tree Farm Licence shown thus: [Symbol]
Roads shown thus: [Symbol]	Quarry Reserve body shown thus: [Symbol]
Highway shown thus: [Symbol]	Ungulate Winter Range body shown thus: [Symbol]
Railway line shown thus: [Symbol]	Visual Land Inventory shown thus: [Symbol]
Seismic line/trail shown thus: [Symbol]	Watershed Reserve body shown thus: [Symbol]
Recreation Tenure shown thus: [Symbol]	Wind Tenure body shown thus: [Symbol]
Drainages shown thus: [Symbol]	Woodlot body shown thus: [Symbol]
Buried cable shown thus: [Symbol]	Fault Line shown thus: [Symbol]
Buried pipe shown thus: [Symbol]	Misc. Reserve/Notation body shown thus: [Symbol]
Overhead powerline shown thus: [Symbol]	Misc. Licence/Permit body shown thus: [Symbol]
Riparian Reserve Zone shown thus: [Symbol]	Stantec Wetland / Classification shown thus: [Symbol]
Riparian Management Zone shown thus: [Symbol]	Crossings shown thus: [Symbol]
Forest Cover Reserve shown thus: [Symbol]	Forest Cover Reserve shown thus: [Symbol]
Archaeological site shown thus: [Symbol]	Residences shown thus: [Symbol]
Agricultural Land Reserve body shown thus: [Symbol]	Nisga'a Lands shown thus: [Symbol]
Coal Tenure body shown thus: [Symbol]	Nisga'a Village Lands shown thus: [Symbol]
Cutblock body shown thus: [Symbol]	Lava Bed Park shown thus: [Symbol]
Fence body shown thus: [Symbol]	

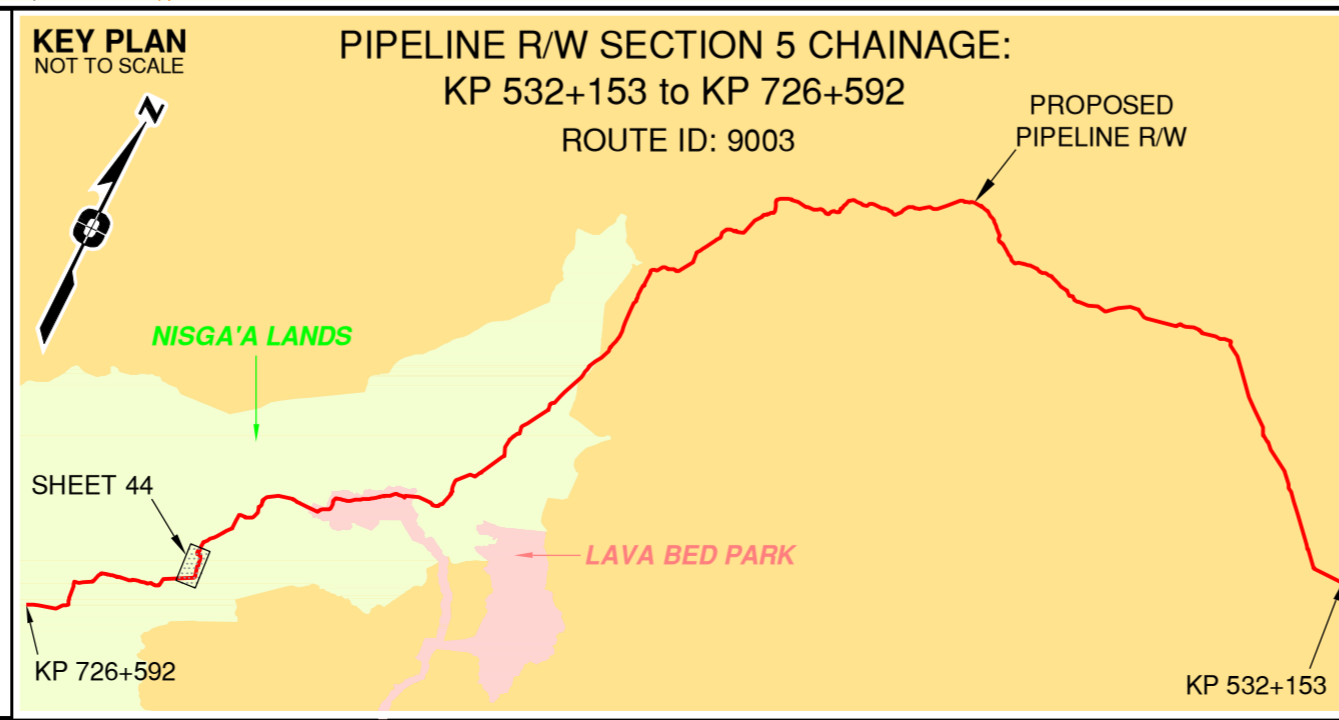

APPROVED BY: _____

PROJECT ENGINEER: _____

No.	STATION	DESCRIPTION	NAD 83 UTM ZONE 9	OWNER
W02753	(S4) 707+250	Tribe to Ksi Mar'in River / S4 / RRZ=0 RMZ=30	N 6101267 E 473846	ILMB
T01084	(S3) 707+059	Road / Condition Unknown	N 6101294 E 474244	Nisga'a Lisims Government
W02039	(S3) 706+846	Tribe to Ksi Mar'in River / S6 / RRZ=0 RMZ=20	N 6101247 E 474493	ILMB
W00617	(S3) 706+802	Trail / Condition Unknown	N 6101240 E 474535	Nisga'a Lisims Government
W02038	(S3) 706+463	Ksi Mar'in River / S1A / RRZ=50 RMZ=20	N 6101322 E 474848	ILMB
W00616	(S3) 706+344	Forestry Road R12574 A (Retired) / Condition Unknown	N 6101378 E 474961	Nisga'a Lisims Government
W00615	(S3) 706+266	Road / Condition Unknown	N 6101437 E 474994	Nisga'a Lisims Government
W02037	(S3) 706+219	Tribe to Ksi Mar'in River / S5 / RRZ=0 RMZ=30	N 6101480 E 475012	ILMB
W02984	(S2) 706+676	Tribe to Ksi Mar'in River / S4 / RRZ=0 RMZ=30	N 6101506 E 474369	ILMB
W00617	(S2) 706+544	Trail / Condition Unknown	N 6101561 E 474489	Nisga'a Lisims Government
W02985	(S2) 706+422	Ksi Mar'in River / S1A / RRZ=50 RMZ=50	N 6101612 E 474600	ILMB
W00616	(S2) 706+181	Forestry Road R12574 A (Retired) / Condition Unknown	N 6101712 E 474819	Nisga'a Lisims Government
W00615	(S2) 706+100	Road / Condition Unknown	N 6101745 E 474892	Nisga'a Lisims Government
W00614	(S1) 705+724	Forestry Road R12574 A (Retired) / Condition Unknown	N 6101935 E 475207	Nisga'a Lisims Government
W02754	(S1) 705+524	Tribe to Ksi Mar'in River / S4 / RRZ=0 RMZ=30	N 6102125 E 475256	ILMB
W02755	(S1) 705+181	Tribe to Ksi Mar'in River / S5 / RRZ=0 RMZ=20	N 6102464 E 474819	ILMB
W02036	(S1) 704+439	Tribe to Ksi Mar'in River / S3 / RRZ=20 RMZ=20	N 6103179 E 475092	ILMB
W02035	(S1) 703+900	Tribe to Ksi Mar'in River / S3 / RRZ=20 RMZ=20	N 6103679 E 475080	ILMB
W02034	(S1) 703+821	Tribe to Ksi Mar'in River / S3 / RRZ=20 RMZ=20	N 6103757 E 475081	ILMB
W00852	(S1) 703+521	Trail / Condition Unknown	N 6104049 E 475017	Nisga'a Lisims Government
W02033	(S1) 703+328	Tribe to Ksi Mar'in River / RRZ=0 RMZ=30	N 6104226 E 474938	ILMB
W00611	(S1) 702+969	Forestry Road / LGGR / R12574 A (Retired)	N 6104316 E 474642	Nisga'a Lisims Government
W00610	(S1) 702+446	Forestry Road / LGGR / R12574 A (Retired)	N 6104709 E 475080	Nisga'a Lisims Government
T00735	(S1) 702+208	Trail / Condition Unknown	N 6104921 E 474675	Nisga'a Lisims Government

Prince Rupert Gas Transmission Project

TransCanada
In business to deliver

PRINCE RUPERT GAS TRANSMISSION LTD.

PROPOSED VARIABLE WIDTH (32 to 90m) PIPELINE R/W FROM d-59-I, 93-M-5 TO c-71-D, 103-P-3 (S1), c-71-D TO d-63-D, 103-P-3 (S2 & S3) & FROM d-63-D, 103-P-3 TO a-71-J, 103-I-13 (S4) (SHEET CHAINAGE: 702+199 TO 707+445)

Unsurveyed Crown Land/Crown Land/Private Land/Nisga'a Lands & Village Lands/Lava Bed Park
Cassiar District & Range 5 Coast District

The intended plot size of this plan is 864mm in width by 560mm in height when plotted at a scale of 1: 5000 (use D size sheet)

BCGS: 103102/93.93M.042/51/52/61, 103P.0030/41/15/25/26/36/46/56/67/68/69/70

Sheet 44 of 49

FOCUS
Focus Surveys (BC) Limited Partnership
10715 - 100th Avenue Fort St. John BC
V1J 1Z3 250.787.0300 www.focus.ca

FOCUS: 130275CP05R1
AFPE: 5005948
TCPL: 004776-09-ML-03-10
ePASS: 10048852

REV. 1

TABLE OF CROSSINGS

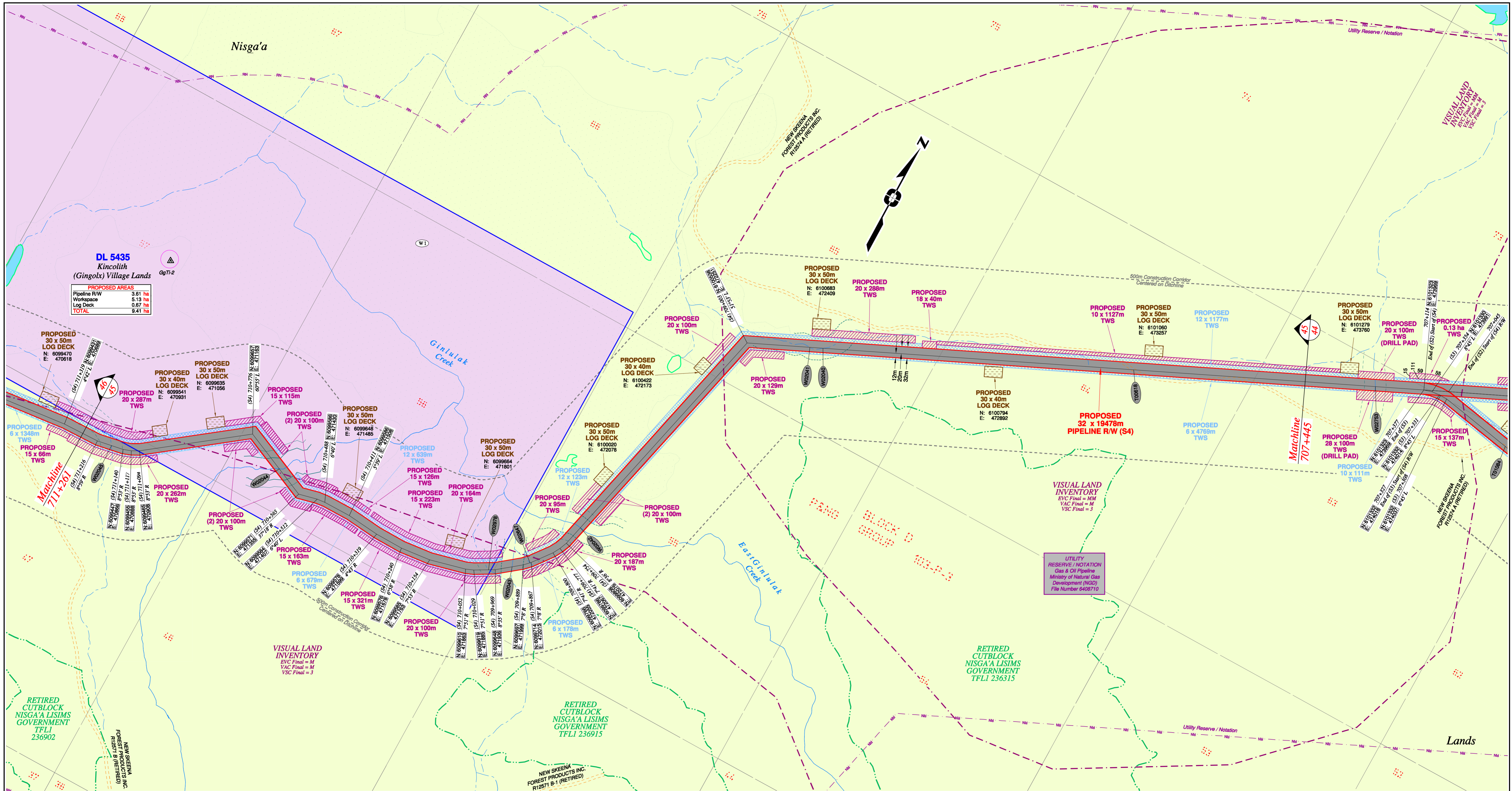

Rev	Revision Description	Date(Y/M/D)	By
0	Original Plan Prepared	2014/09/19	DC
1	Construction Plan Based on Rev.0 (2014/09/12) Except for New Construction Corridor: Shape, Label, Area Table & ePass Corrected Area on (S1)	2014/12/31	DC

LEGEND	
Proposed Pipeline R/W shown thus: [Symbol]	Fish/Wildlife Reserve body shown thus: [Symbol]
Proposed Temp. Workspaces shown thus: TWS / TWS	Grazing Tenure body shown thus: [Symbol]
Proposed Log Decks & Storage Sites shown thus: [Symbol]	Mineral Claim body shown thus: [Symbol]
Right of Way shown thus: [Symbol]	Tree Farm Licence shown thus: [Symbol]
Roads shown thus: [Symbol]	Quarry Reserve body shown thus: [Symbol]
Highway shown thus: [Symbol]	Ungulate Winter Range body shown thus: UWR
Railway line shown thus: [Symbol]	Visual Land Inventory shown thus: [Symbol]
Seismic line/trail shown thus: [Symbol]	Watershed Reserve body shown thus: [Symbol]
Drainages shown thus: [Symbol]	Wind Tenure body shown thus: [Symbol]
Buried cable shown thus: [Symbol]	Woodlot body shown thus: [Symbol]
Buried pipe shown thus: [Symbol]	Fault Line shown thus: [Symbol]
Overhead powerline shown thus: [Symbol]	Misc. Reserve/Notation body shown thus: [Symbol]
Riparian Reserve Zone shown thus: [Symbol]	Misc. Licence/Permit body shown thus: [Symbol]
Riparian Management Zone shown thus: [Symbol]	Stantec Wetland / Classification shown thus: [Symbol]
Forest Cover Reserve shown thus: [Symbol]	Crossings shown thus: [Symbol]
Archaeological site shown thus: [Symbol]	Old Growth Management Area shown thus: [Symbol]
Agricultural Land Reserve body shown thus: ALR	Residences shown thus: [Symbol] Power Pole shown thus: [Symbol]
Coal Tenure body shown thus: [Symbol]	Nisga'a Lands shown thus: [Symbol]
Cutblock body shown thus: [Symbol]	Nisga'a Village Lands shown thus: [Symbol]
Fence body shown thus: [Symbol]	Lava Bed Park shown thus: [Symbol]

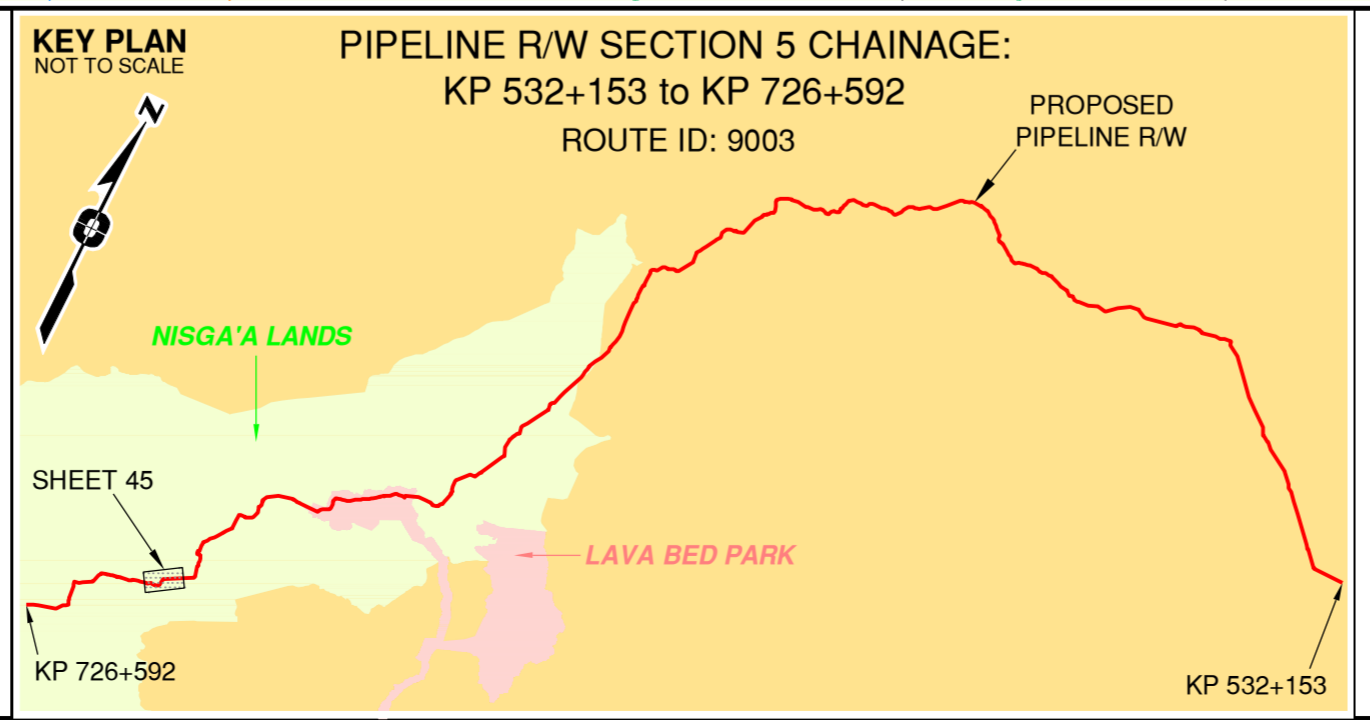

APPROVED BY _____

PROJECT ENGINEER _____

No.	STATION	DESCRIPTION	NAD 83 UTM ZONE	OWNER
W02045	(S4) 711+175	Trib to Ginulak Creek / S4 / RRZ=0 RMZ=30	N 6099441 E 470833	ILMB
W02044	(S4) 710+655	Ginulak Creek / S2 / RRZ=30 RMZ=20	N 6099607 E 471274	ILMB
W02978	(S4) 709+988	Trib to East Ginulak Creek / S6 / RRZ=0 RMZ=20	N 6099639 E 471920	ILMB
W02043	(S4) 709+922	Trib to East Ginulak Creek / S2 / RRZ=30 RMZ=20	N 6099678 E 471974	ILMB
W02647	(S4) 709+871	Trib to East Ginulak Creek / S6 / RRZ=0 RMZ=20	N 6099711 E 472013	ILMB
W02042	(S4) 709+697	East Ginulak Creek / S2 / RRZ=30 RMZ=20	N 6099864 E 472089	ILMB
W02041	(S4) 708+829	Trib to Nass River / RRZ=0 RMZ=20	N 6100610 E 472411	ILMB
W02040	(S4) 708+792	Trib to Nass River / S4 / RRZ=0 RMZ=30	N 6100626 E 472444	ILMB
T00618	(S4) 707+925	Forestry Road R12597 A (Retired) / Condition Unknown	N 6100987 E 473233	Nisga'a Lisims Government

Prince Rupert Gas Transmission Project

TransCanada
In business to deliver

PRINCE RUPERT GAS TRANSMISSION LTD.

PROPOSED VARIABLE WIDTH (32 to 90m) PIPELINE R/W FROM d-59-I, 93-M-5 TO c-71-D, 103-P-3 (S1), c-71-D TO d-63-D, 103-P-3 (S2 & S3) & FROM d-63-D, 103-P-3 TO a-71-J, 103-I-13 (S4) (SHEET CHAINAGE: 707+445 TO 711+261)

Unsurveyed Crown Land/Crown Land/Private Land/Nisga'a Lands & Village Lands/Lava Bed Park
Cassiar District & Range 5 Coast District

The intended plot size of this plan is 864mm in width by 560mm in height when plotted at a scale of 1: 5000 (use D size sheet)

BCGS: 1031.092/93.93M.042/51/52/61.103P.003/04/14/15/25/26/36/46/56/67/68/69/70

Sheet 45 of 49

FOCUS
Focus Surveys (BC) Limited Partnership
10715 - 100th Avenue, Fort St. John, BC
V1J 1Z3, 250.787.0300, www.focus.ca

FOCUS: 130275CP05R1
AFE: 5005948
TCPL: 004776-09-ML-03-181
ePASS: 10048852

REV. 1



PROPOSED AREAS

Pipeline R/W	3.61 ha
Workspace	5.13 ha
Log Deck	0.87 ha
TOTAL	9.61 ha

Rev	Revision Description	Date(Y/M/D)	By
0	Original Plan Prepared	2014/09/19	DC
1	Construction Plan Based on Rev.0 (2014/09/19) Except for New Construction Corridor: Shape, Label, Area Table & ePass Corrected Area on (S1)	2014/12/31	DC

NOTES:

- Co-ordinates are NAD 83 Grid, UTM Zone 9 and Zone 10. Distances shown are in metres and decimals thereof. Chainages are two-dimensional and are on pipeline ditchline. Pipeline segment length derived from BGC Desktop Study dated December 20, 2013.
- Fault Lines data has been provided from BGC Engineering Inc. Desktop Study dated December 20, 2013.
- Water crossing information has been provided by Stantec. Wetlands data has been provided by Stantec dated August 29, 2014. Freshwater Atlas wetlands outside of construction corridor have been removed from scenery.
- Cutblock data is confirmed using information from the Government of BC websites for Forest MapView and MapBC.
- This pipeline section is partially within the Agricultural Land Reserve.
- Field Survey Completed July 15, 2014
- This plan represents the best information available at the time of survey. Focus Surveys and its employees take no responsibility for the location of any underground conduits, pipes, or other facilities whether shown on or omitted from this plan. All underground installations should be located by the respective authorities prior to construction.

LEGEND

Proposed Pipeline R/W shown thus:	Fish/Wildlife Reserve bdy shown thus:
Proposed Temp. Workspaces shown thus:	Grazing Tenure bdy shown thus:
Proposed Log Decks & Storage Sites shown thus:	Mineral Claim bdy shown thus:
Right of Way shown thus:	Tree Farm Licence shown thus:
Roads shown thus:	Quarry Reserve bdy shown thus:
Highway shown thus:	Ungulate Winter Range bdy shown thus:
Railway line shown thus:	Visual Land Inventory shown thus:
Seismic line/trail shown thus:	Watershed Reserve bdy shown thus:
Drainages shown thus:	Recreation Tenure shown thus:
Buried cable shown thus:	Woodlot bdy shown thus:
Buried pipe shown thus:	Fault Line shown thus:
Overhead powerline shown thus:	Misc. Reserve/Notation bdy shown thus:
Riparian Reserve Zone shown thus:	Misc. Licence/Permit bdy shown thus:
Riparian Management Zone shown thus:	Stantec Wetland / Classification shown thus:
Forest Cover Reserve shown thus:	Crossings shown thus:
Archaeological site shown thus:	Old Growth Management Area shown thus:
Agricultural Land Reserve bdy shown thus:	Residences shown thus:
Coal Tenure bdy shown thus:	Nisga'a Lands shown thus:
Cutblock bdy shown thus:	Nisga'a Village Lands shown thus:
Fence bdy shown thus:	Lava Bed Park shown thus:

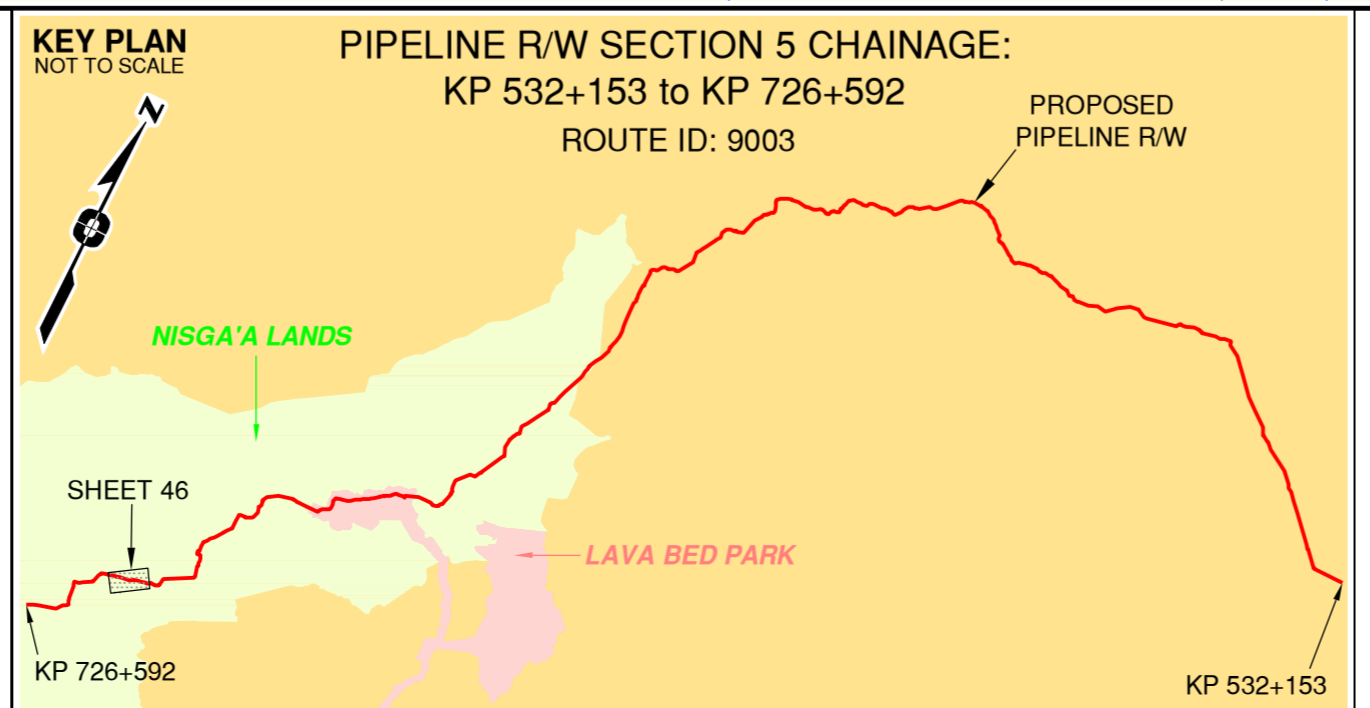

APPROVED BY _____

PROJECT ENGINEER _____

TABLE OF CROSSINGS

No.	STATION	DESCRIPTION	NAD 83 UTM ZONE 9	OWNER
W00885	(S4) 714+754	Trail / Condition Unknown	N 6098864 E 467349	Nisga'a Usims Government
W02752	(S4) 714+498	Trib to Nass River / S6 / RRZ-0 RMZ-20	N 6098884 E 467605	ILMB
W02049	(S4) 713+581	Trib to Nass River / S6 / RRZ-0 RMZ-20	N 6099015 E 468504	ILMB
W02050	(S4) 713+526	Trib to Nass River / S5 / RRZ-0 RMZ-30	N 6099018 E 468558	ILMB
W02048	(S4) 713+386	Trib to Nass River / S5 / RRZ-0 RMZ-30	N 6099025 E 468698	ILMB
W02648	(S4) 712+664	Trib to Ginuluk Creek / S4 / RRZ-0 RMZ-30	N 6099231 E 469367	ILMB
W02047	(S4) 712+597	Trib to Ginuluk Creek / S2 / RRZ-0 RMZ-20	N 6099253 E 469430	ILMB
T01018	(S4) 712+110	Forestry Road / R12571 B (Retired)	N 6099358 E 469902	Nisga'a Usims Government
W02046	(S4) 711+780	Trib to Ginuluk Creek / S6 / RRZ-0 RMZ-20	N 6099382 E 470231	ILMB

Prince Rupert Gas Transmission Project

TransCanada
In business to deliver

PRINCE RUPERT GAS TRANSMISSION LTD.

PROPOSED VARIABLE WIDTH (32 TO 90m) PIPELINE R/W FROM d-59-I, 93-M-5 TO c-71-D, 103-P-3 (S1), c-71-D TO d-63-D, 103-P-3 (S2 & S3) & FROM d-63-D, 103-P-3 TO a-71-J, 103-I-13 (S4) (SHEET CHAINAGE: 711+261 TO 715+137)

Unsurveyed Crown Land/Crown Land/Private Land/Nisga'a Lands & Village Lands/Lava Bed Park
Cassiar District & Range 5 Coast District

The intended plot size of this plan is 864mm in width by 560mm in height when plotted at a scale of 1: 5000 (use D size sheet)

BCGS: 1031-092/93.93M.042/51/52/61, 103P.003/04/14/15/25/26/36/46/56/67/68/69/70

Sheet 46 of 49

FOCUS
Focus Surveys (BC) Limited Partnership
10715 - 100th Avenue Fort St. John BC
V1J 1Z3 250.787.6300 www.focus.ca

FOCUS: 130275CP05R1
AFE: 5005948
TCPL: 004776-09-ML-03-182
ePASS: 10048852

REV. **1**



Rev	Revision Description	Date(Y/M/D)	By
0	Original Plan Prepared	2014/09/19	DC
1	Construction Plan Based on Rev.0 (2014/09/12) Except for New Construction Corridor: Shape, Label, Area Table & ePass Corrected Area on (S1)	2014/12/31	DC

LEGEND	
Proposed Pipeline R/W shown thus: [Symbol]	Fish/Wildlife Reserve body shown thus: [Symbol]
Proposed Temp. Workspaces shown thus: TWS / TWS	Grazing Tenure body shown thus: [Symbol]
Proposed Log Decks & Storage Sites shown thus: [Symbol]	Mineral Claim body shown thus: [Symbol]
Right of Way shown thus: [Symbol]	Tree Farm Licence shown thus: [Symbol]
Roads shown thus: [Symbol]	Quarry Reserve body shown thus: [Symbol]
Highway shown thus: [Symbol]	Ungulate Winter Range body shown thus: UWR
Railway line shown thus: [Symbol]	Visual Land Inventory shown thus: [Symbol]
Seismic line/trail shown thus: [Symbol]	Watershed Reserve body shown thus: [Symbol]
Recreation Tenure shown thus: [Symbol]	Wind Tenure body shown thus: [Symbol]
Drainages shown thus: [Symbol]	Woodlot body shown thus: WL
Buried cable shown thus: [Symbol]	Fault Line shown thus: [Symbol]
Buried pipe shown thus: [Symbol]	Misc. Reserve/Notation body shown thus: [Symbol]
Overhead powerline shown thus: [Symbol]	Misc. Licence/Permit body shown thus: [Symbol]
Riparian Reserve Zone shown thus: [Symbol]	Stantec Wetland / Classification shown thus: [Symbol]
Riparian Management Zone shown thus: [Symbol]	Crossings shown thus: [Symbol]
Forest Cover Reserve shown thus: [Symbol]	Old Growth Management Area shown thus: [Symbol]
Archaeological site shown thus: [Symbol]	Residences shown thus: [Symbol]
Agricultural Land Reserve body shown thus: ALR	Nisga'a Lands shown thus: [Symbol]
Coal Tenure body shown thus: [Symbol]	Nisga'a Village Lands shown thus: [Symbol]
Cutblock body shown thus: [Symbol]	Lava Bed Park shown thus: [Symbol]
Fence body shown thus: [Symbol]	

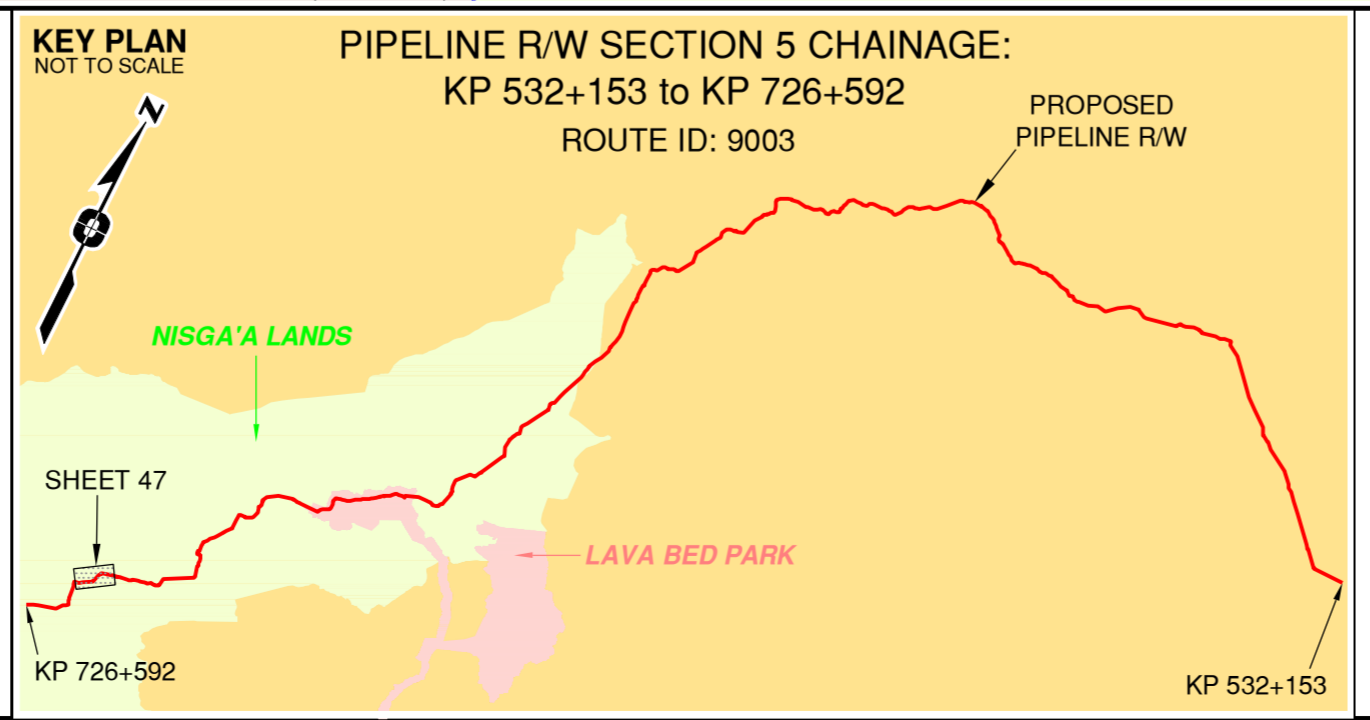

APPROVED BY _____

PROJECT ENGINEER _____

No.	STATION	DESCRIPTION	NAD 83 UTM ZONE	OWNER
W02054	(S4) 719+128	Quilgauw Creek / S1 / RRZ=50 RMZ=20	N 6096741 E 4639300	ILMB
W02053	(S4) 718+654	Trib to Quilgauw Creek / S2 / RRZ=30 RMZ=20	N 6096940 E 4643500	ILMB
T00882	(S4) 717+072	Trail / Condition Unknown	N 6097838 E 4655556	Nisga'a Lisims Government
T00619	(S4) 716+212	Trail / Condition Unknown	N 6098585 E 4659455	Nisga'a Lisims Government
W02234	(S4) 716+169	Trib to Nass River / S2 / RRZ=30 RMZ=20	N 6098602 E 4659585	ILMB
W02233	(S4) 716+862	Trib to Nass River / Beaver Dam Complex / RRZ=0 RMZ=30	N 6098699 E 4662776	ILMB
W02748	(S4) 715+711	Trib to Nass River / S6 / RRZ=0 RMZ=20	N 6098727 E 4664272	ILMB
W02735	(S4) 715+681	Trib to Nass River / S6 / RRZ=0 RMZ=20	N 6098718 E 4664511	ILMB
W02750	(S4) 715+585	Trib to Nass River / S6 / RRZ=0 RMZ=20	N 6098698 E 4665433	ILMB
W02751	(S4) 715+406	Trib to Nass River / S6 / RRZ=0 RMZ=20	N 6098757 E 4667122	ILMB
W02051	(S4) 715+188	Trib to Nass River / S3 / RRZ=20 RMZ=20	N 6098819 E 4669211	ILMB

Prince Rupert Gas Transmission Project

TransCanada
In business to deliver

PRINCE RUPERT GAS TRANSMISSION LTD.

PROPOSED VARIABLE WIDTH (32 to 90m) PIPELINE R/W FROM d-59-I, 93-M-5 TO c-71-D, 103-P-3 (S1), c-71-D TO d-63-D, 103-P-3 (S2 & S3) & FROM d-63-D, 103-P-3 TO a-71-J, 103-I-13 (S4) (SHEET CHAINAGE: 715+137 TO 719+241)

Unsurveyed Crown Land/Crown Land/Private Land/Nisga'a Lands & Village Lands/Lava Bed Park/Cassiar District & Range 5 Coast District

The intended plot size of this plan is 864mm in width by 560mm in height when plotted at a scale of 1: 5000 (use D size sheet)

BCGS: 1031.092/93.93M.042/51/52/61, 103P.003/04/14/15/25/26/36/46/56/67/68/69/70

FOCUS: 130275CP05R1
AFE: 5005948
TCPL: 004776-09-ML-03-183
ePASS: 10048852

FOCUS: (BC) Limited Partnership
10715 - 100th Avenue, Fort St. John, BC
V1J 1Z3, 250.787.0300, www.focus.ca

1301/2014 9:30:05 AM

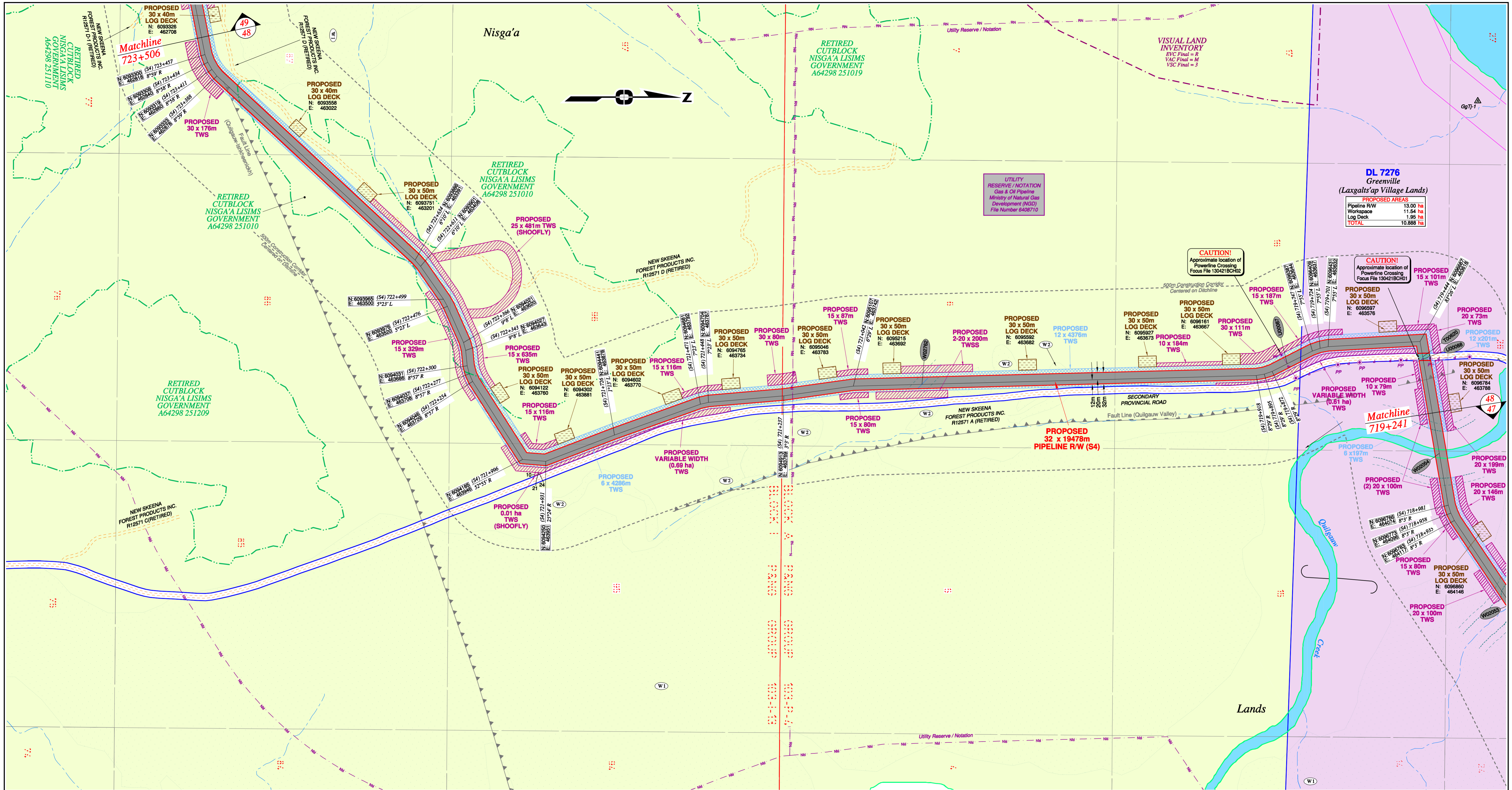

Rev	Revision Description	Date(Y/M/D)	By
0	Original Plan Prepared	2014/09/19	DC
1	Construction Plan Based on Rev.0 (2014/09/12) Except for New Construction Corridor: Shape, Label, Area Table & ePass Corrected Area on (S1)	2014/12/31	DC

LEGEND	
Proposed Pipeline R/W shown thus: [Symbol]	Fish/Wildlife Reserve body shown thus: [Symbol]
Proposed Temp. Workspaces shown thus: TWS / TWS	Grazing Tenure body shown thus: [Symbol]
Proposed Log Decks & Storage Sites shown thus: [Symbol]	Mineral Claim body shown thus: [Symbol]
Right of Way shown thus: [Symbol]	Tree Farm Licence shown thus: [Symbol]
Roads shown thus: [Symbol]	Quarry Reserve body shown thus: [Symbol]
Highway shown thus: [Symbol]	Ungulate Winter Range body shown thus: UWR
Railway line shown thus: [Symbol]	Visual Land Inventory shown thus: [Symbol]
Seismic line/trail shown thus: [Symbol]	Watershed Reserve body shown thus: [Symbol]
Recreation Tenure shown thus: [Symbol]	Wind Tenure body shown thus: [Symbol]
Drainages shown thus: [Symbol]	Woodlot body shown thus: [Symbol]
Buried cable shown thus: [Symbol]	Fault Line shown thus: [Symbol]
Buried pipe shown thus: [Symbol]	Misc Reserve/Notation body shown thus: [Symbol]
Overhead powerline shown thus: [Symbol]	Misc Licence/Permit body shown thus: [Symbol]
Stantec Wetland / Classification shown thus: [Symbol]	Riparian Reserve Zone shown thus: [Symbol]
Riparian Management Zone shown thus: [Symbol]	Crossings shown thus: [Symbol]
Forest Cover Reserve shown thus: [Symbol]	Old Growth Management Area shown thus: [Symbol]
Archaeological site shown thus: [Symbol]	Residences shown thus: [Symbol] Power Pole shown thus: [Symbol]
Agricultural Land Reserve body shown thus: [Symbol]	Nisga'a Lands shown thus: [Symbol]
Coal Tenure body shown thus: [Symbol]	Nisga'a Village Lands shown thus: [Symbol]
Cutblock body shown thus: [Symbol]	Lava Bed Park shown thus: [Symbol]
Fence body shown thus: [Symbol]	

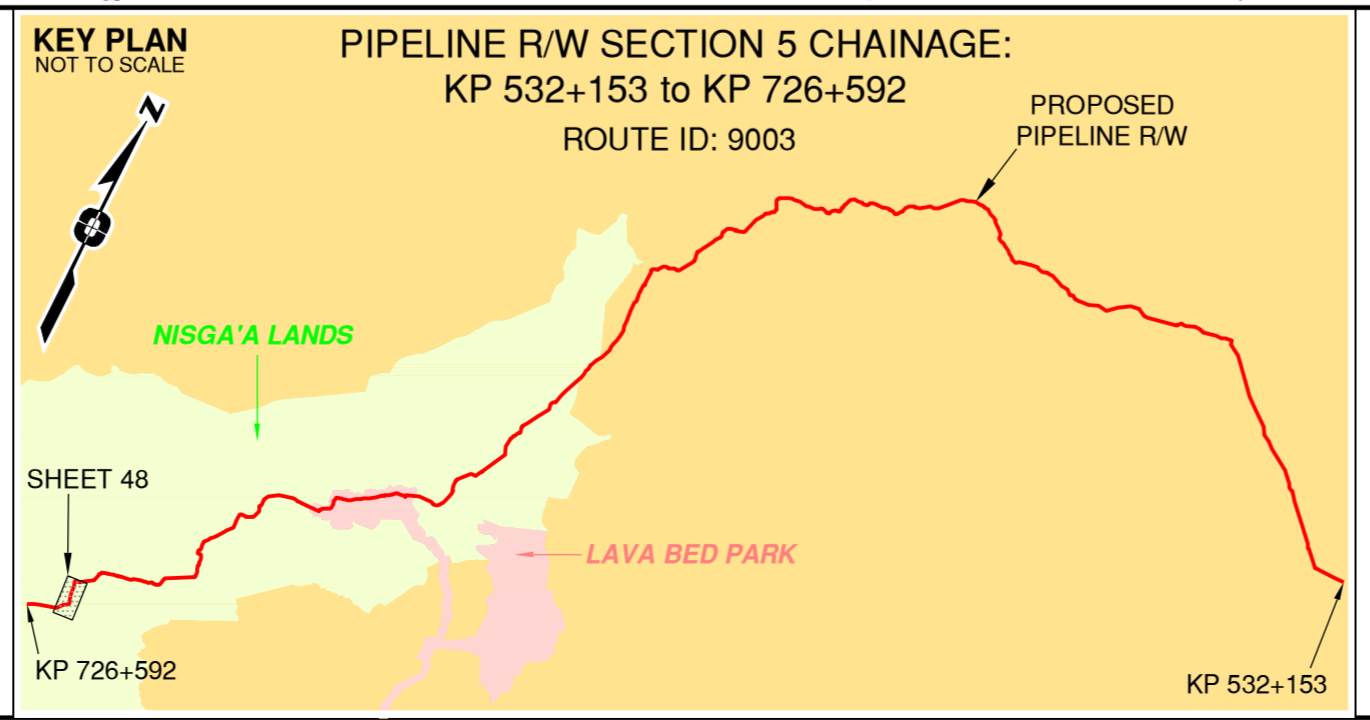

APPROVED BY _____

PROJECT ENGINEER _____

No.	STATION	DESCRIPTION	NAD 83 UTM ZONE	OWNER
W02762	(S4) 720+851	Trib to Quilguaw Creek / RRZ=0 RMZ=20	N 6095299 E 463737	ILMB
U00087	(S4) 719+826	Overhead Powerline	N 6096317 E 463680	BC Hydro
T00620	(S4) 719+401	Forestry Road / Condition Unknown / R12571 A (Retired)	N 6096695 E 463660	Nisga'a Lisims Government
U00088	(S4) 719+395	Overhead Powerline	N 6096696 E 463667	BC Hydro

TABLE OF CROSSINGS

Prince Rupert Gas Transmission Project

PRINCE RUPERT GAS TRANSMISSION LTD.

PROPOSED VARIABLE WIDTH (32 to 90m) PIPELINE R/W FROM d-59-I, 93-M-5 TO c-71-D, 103-P-3 (S1), c-71-D TO d-63-D, 103-P-3 (S2 & S3) & FROM d-63-D, 103-P-3 TO a-71-J, 103-I-13 (S4) (SHEET CHAINAGE: 719+241 TO 723+506)

Unsurveyed Crown Land/Crown Land/Private Land/Nisga'a Lands & Village Lands/Lava Bed Park/Cassiar District & Range 5 Coast District

The intended plot size of this plan is 864mm in width by 560mm in height when plotted at a scale of 1: 5000 (use D size sheet)

BCGS: 1031.092/93.93M.042/51/52/61.103P.003/04/14/15/25/26/36/46/56/57/67/68/69/70

Sheet 48 of 49

FOCUS Focus Surveys (BC) Limited Partnership
10715 - 100th Avenue, Fort St. John, BC V1J 1Z3, 250.787.0300, www.focus.ca

FOCUS: 130275CP05R1
AFE: 5005948
TCPL: 004776-09-ML-03-184
ePASS: 10048852

REV. 1



Rev	Revision Description	Date(Y/M/D)	By
0	Original Plan Prepared	2014/09/19	DC
1	Construction Plan Based on Rev.0 (2014/09/12) Except for New Construction Corridor: Shape, Label, Area Table & ePass Corrected Area on (S1)	2014/12/31	DC

LEGEND	
Proposed Pipeline R/W shown thus: [Red line]	Fish/Wildlife Reserve body shown thus: [Blue wavy line]
Proposed Temp. Workspaces shown thus: [Pink hatched area]	Grazing Tenure body shown thus: [Green dashed line]
Proposed Log Decks & Storage Sites shown thus: [Yellow rectangle]	Mineral Claim body shown thus: [Blue dashed line]
Right of Way shown thus: [Red dashed line]	Tree Farm Licence shown thus: [Green dashed line]
Roads shown thus: [Black dashed line]	Quarry Reserve body shown thus: [Red dashed line]
Highway shown thus: [Black dashed line with 'H']	Ungulate Winter Range body shown thus: [Green dashed line]
Railway line shown thus: [Black dashed line with 'R']	Visual Land Inventory shown thus: [Blue dashed line]
Seismic line/trail shown thus: [Black dashed line with 'S']	Watershed Reserve body shown thus: [Blue dashed line]
Recreation Tenure shown thus: [Green dashed line]	Wind Tenure body shown thus: [Blue dashed line]
Drainages shown thus: [Blue dashed line]	Woodlot body shown thus: [Green dashed line]
Buried cable shown thus: [Black dashed line with 'C']	Fault Line shown thus: [Black dashed line with 'F']
Buried pipe shown thus: [Black dashed line with 'P']	Misc. Reserve/Notation body shown thus: [Black dashed line with 'M']
Overhead powerline shown thus: [Black dashed line with 'P']	Misc. Licence/Permit body shown thus: [Black dashed line with 'M']
Riparian Reserve Zone shown thus: [Blue dashed line]	Stantec Wetland / Classification shown thus: [Black dashed line with 'W']
Riparian Management Zone shown thus: [Blue dashed line]	Crossings shown thus: [Black dashed line with 'X']
Forest Cover Reserve shown thus: [Green dashed line]	Old Growth Management Area shown thus: [Black dashed line with 'O']
Archaeological site shown thus: [Black dashed line with 'A']	Residences shown thus: [Black dashed line with 'R']
Agricultural Land Reserve body shown thus: [Green dashed line]	Nisga'a Village Lands shown thus: [Black dashed line with 'N']
Coal Tenure body shown thus: [Black dashed line with 'C']	Lava Bed Park shown thus: [Black dashed line with 'L']
Cutblock body shown thus: [Black dashed line with 'C']	Fence body shown thus: [Black dashed line with 'F']

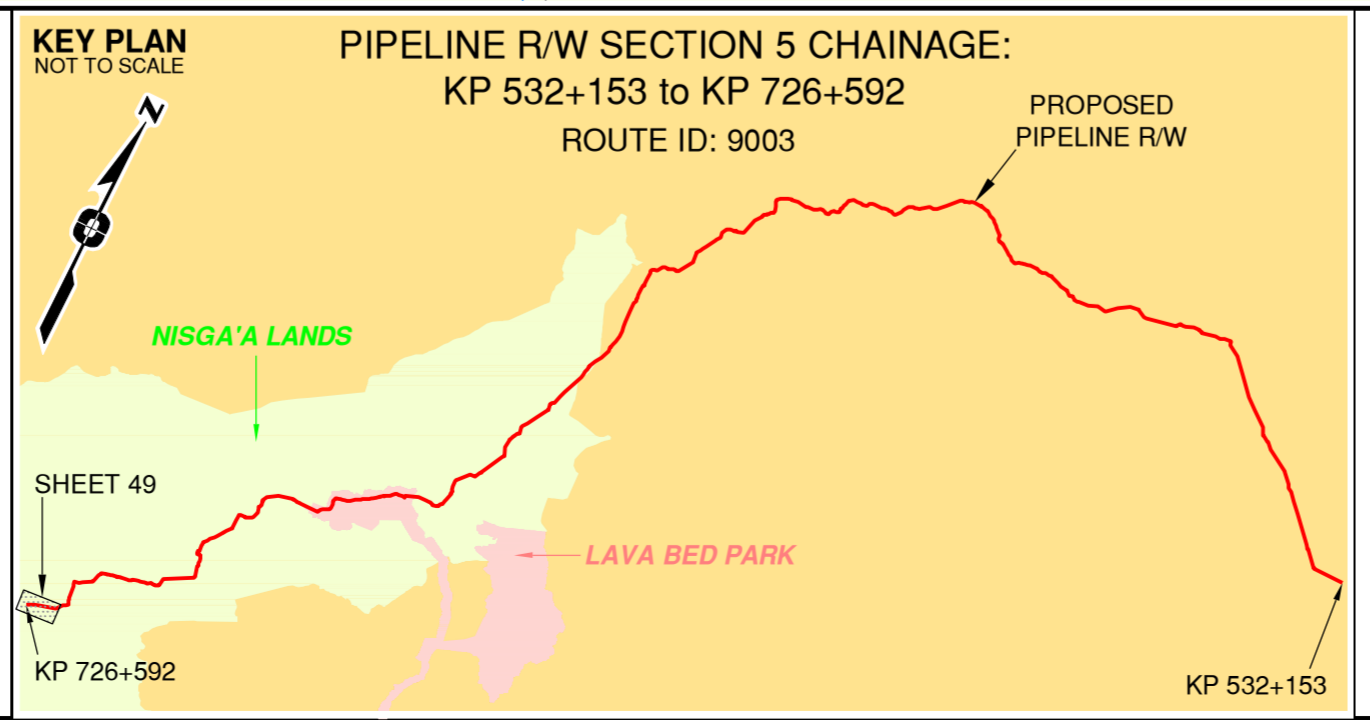

APPROVED BY _____

PROJECT ENGINEER _____

No.	STATION	DESCRIPTION	NAD 83 UTM ZONE 9	OWNER
W02056	(S4) 725+779	Trib to Ksi Hlginx River / S2 / RRZ=30 RMZ=20	N 6092809 E 460550	ILMB
W02634	(S4) 724+957	Trib to Ksi Hlginx River / RRZ=0 RMZ=20	N 6093008 E 461347	ILMB
W02633	(S4) 724+863	Trib to Ksi Hlginx River / RRZ=0 RMZ=20	N 6093026 E 461439	ILMB
W02057	(S4) 724+678	Ksi Hlginx River / S1 / RRZ=50 RMZ=20	N 6093062 E 461621	ILMB
W02632	(S4) 724+506	Trib to Ksi Hlginx River / RRZ=0 RMZ=20	N 6093096 E 461790	ILMB
T00622	(S4) 724+130	Trail / Condition Unknown	N 6093169 E 462158	Nisga'a Lisims Government
T00621	(S4) 723+857	Forestry Road / Condition Unknown	N 6093222 E 462427	Nisga'a Lisims Government
T01014	(S4) 723+727	Forestry Road / R12571 D-1 (Retired)	N 6093249 E 462554	Nisga'a Lisims Government
W02055	(S4) 723+718	Trib to Ksi Hlginx River / S5 / RRZ=0 RMZ=30	N 6093249 E 462553	ILMB

Prince Rupert Gas Transmission Project 

PRINCE RUPERT GAS TRANSMISSION LTD.

PROPOSED VARIABLE WIDTH (32 TO 90m) PIPELINE R/W FROM d-59-I, 93-M-5 TO c-71-D, 103-P-3 (S1), c-71-D TO d-63-D, 103-P-3 (S2 & S3) & FROM d-63-D, 103-P-3 TO a-71-J, 103-I-13 (S4) (SHEET CHAINAGE: 723+506 TO 726+592)

Unsurveyed Crown Land/Crown Land/Private Land/Nisga'a Lands & Village Lands/Lava Bed Park/Cassiar District & Range 5 Coast District

The intended plot size of this plan is 864mm in width by 560mm in height when plotted at a scale of 1: 5000 (use D size sheet)

BCGS: 1031.092/93.93M.042/51/52/61.103P.003/04/14/15/25/26/36/46/56/67/68/69/70

Sheet 49 of 49

FOCUS Focus Surveys (BC) Limited Partnership 10716 - 100th Avenue Fort St. John BC V1J 2Z3 250.757.0300 www.focus.ca	FOCUS: 130275CP05R1 AFE: 5005948 TCPL: 004776-09-ML-03-185 ePASS: 10048852	REV. 1
--	---	------------------